

Note: Improvements on this lot are not in a flood hazard area.

MICROFILMED

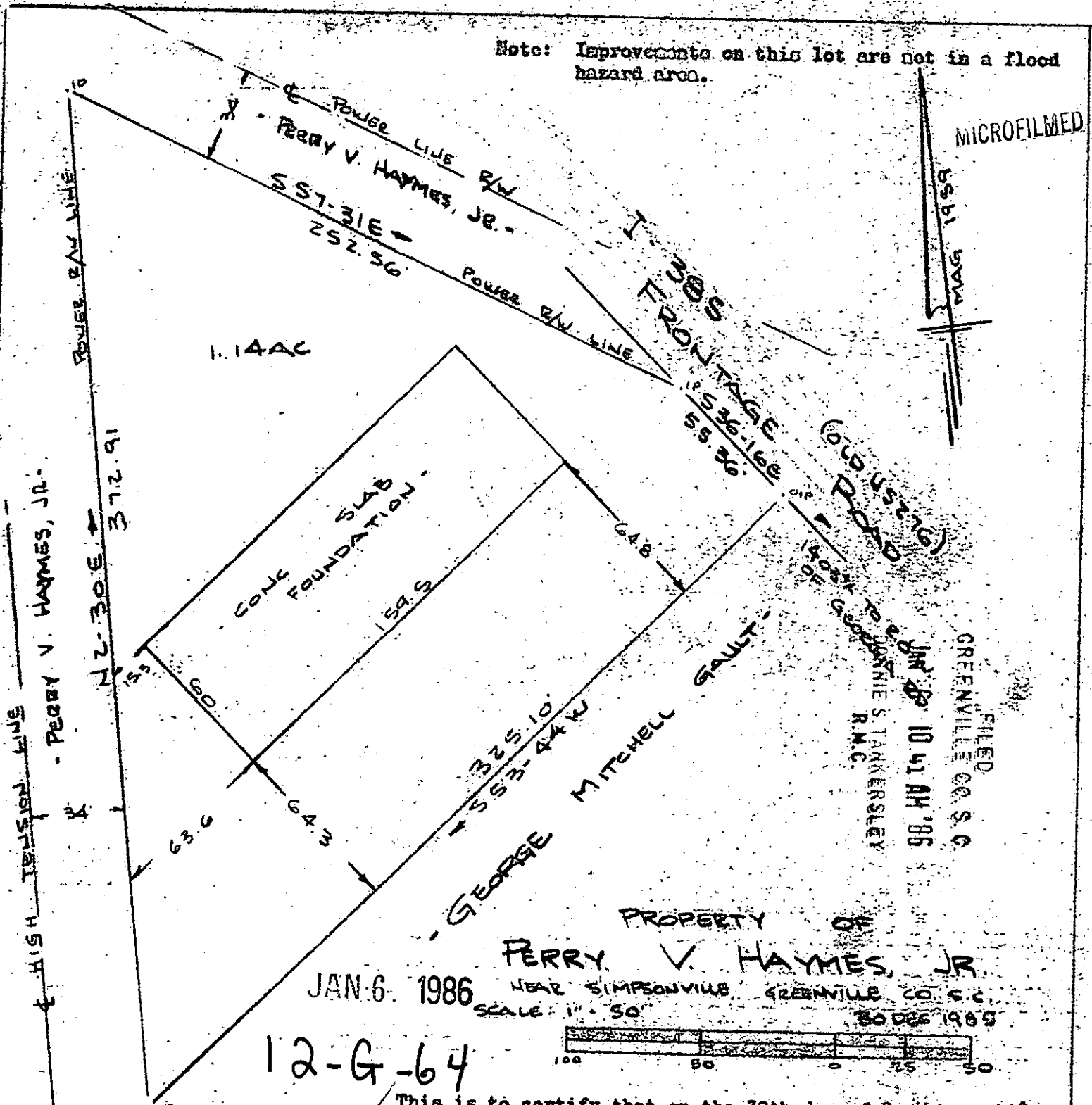

OLD US 210
JACKIE ATKINS & GLENN V. THRIFT
R.M.C.

FILED
GREENVILLE CO. S. C.
JAN 28 10 41 AM '86
R.M.C.

PROPERTY OF
PERRY V. HAYMES, JR.
NEAR SIMPSONVILLE, GREENVILLE CO. S. C.

JAN 6 1986

SCALE: 1" = 50'
50 DEC 1985

12-G-64

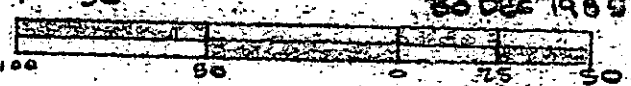

22391

SOUTH CAROLINA
REGISTERED
LAND
SURVEYOR
ROBERT S. BRUCE
1980

This is to certify that on the 30th day of December, 1985, I surveyed the property shown on this plat, being known as 1.14 acres on plat of JACKIE E. ATKINS & GLENN V. THRIFT and recorded in the REC Office Greenville County, S. C., in Plat Book " 11 - X " at Pages 41 & 42 and also known as PROPERTY OF PERRY V. HAYMES, JR. and recorded in Plat Book at Page ; and that the property lines, walls and buildings are as shown hereon, and that the walls and buildings located on said lot do not encroach or project on adjacent street or property, and that no adjacent walls or buildings encroach or project on said premises, and no power lines cross this property except as shown hereon

R. S. Bruce
R. S. Bruce, RLS # 10288

CAROLINA SURVEYING CO., Greenville, S. C.